

southco
 PROPRIETARY ITEM - EXCEPT FOR USES EXPRESSLY GRANTED IN WRITING, INFORMATION DISCLOSED HEREON IS CONFIDENTIAL AND ALL RIGHTS, PATENT AND OTHERWISE ARE RESERVED BY SOUTHCO, INC.

REV	DATE	DRAWN/CHKD	DESCRIPTION	DESCRIPTION	MATERIAL	FINISH/COLOR	DESCRIPTION	MATERIAL	DATE	DRAWN/CHKD	SCALE	DRAWING NUMBER
A	03NOV2008	IR/DLH	RELEASED FOR PRODUCTION	HANDLE	ZAMAC 3	BLACK POWDERCOAT	HANDLE COVER	STEEL	26 JUN 08	IR/ACH	DNS	J-H3-60-301-1
B	09 DEC 08	IR/ACH	PRN: P2008-1345	HOUSING			DISC SPRING					
C	04 FEB 09	IR/ACH	PRN: P2009-0162	MOUNTING CUP			DUMMY CAM					
D	22AUG2011	MJS/MSR	PRN: P2011-1073	TOOL ACTUATOR			CAM SCREW					
E	22SEP2014	CMS/BGL	PRN: P2014-1872	SHAFT			M4x7 SPRKS					
F	06OCT2018	CMS/CDW	PRN: P2018-2534	ROTATION LIMITER			HANDLE PIN					
				LOCKING PAWL			PAWL SPRING					
				LOCK PLUG			WAVE WASHER					
				DIN LOCK ASSY			PADLOCK HASP					
				PANEL GASKETS			RETAINER					
				DIN DUST COVER	SANTOPRENE	NATURAL/BLACK	SHAFT O-RING	BUNA-N				
				HANDLE BUMPER	BUNA-N		SCREW O-RINGS					

DRAWING NUMBER
 J-H3-60-301-1
 MILLIMETERS
 ALL DIMENSIONS WITHOUT TOLERANCES ARE FOR REFERENCE ONLY.
 A3
 THIRD ANGLE PROJECTION
 SHEET 1 OF 2

PART NUMBER: H3-60-A LL -1 FF

- PADLOCK/SERIES: LOCKING OPTION: ASSEMBLY FINISH:
- 1, 2 = COVERED IN J-H3-60-101-0 OR J-H3-60-101-1
 - 3 = NO PADLOCK, ACTUATOR
 - 4 = PADLOCK, ACTUATOR
 - 00 = NO LOCK PROVIDED (DIN ONLY)
 - 01 = CH751
 - 02 = 300
 - 03 = 333
 - 04 = NON LOCKING
 - 05 = HL450
 - 20 = NON LOCKING DIN WITH DETENT
 - 21 = DIN CH751
 - 22 = DIN 300
 - 23 = DIN 333
 - 24 = DIN W/O LOCK PLUG
 - 40 = TOOL, 3mm DOUBLE BIT
 - 41 = TOOL, 5mm DOUBLE BIT
 - 42 = TOOL, TELCORDIA 216 (BELLCORE)
 - 43 = TOOL, ELECTRONICS KEY
 - 47 = TOOL, 8mm TRIANGLE
 - 70 = DIN TOOL, 3mm DOUBLE BIT
 - 71 = DIN TOOL, 5mm DOUBLE BIT
 - 72 = DIN TOOL, TELCORDIA 216
 - 73 = DIN TOOL, ELECTRONICS KEY
 - 77 = DIN TOOL, 8mm TRIANGLE
- OTHERS AVAILABLE UPON REQUEST

GRIP TABLE
 CAM
 PART No. E5-61YY

YY	GRIP	YY	GRIP
07	10.3	15	26.3
08	12.3	16	28.3
09	14.3	17	30.3
10	16.3	18	32.3
11	18.3	19	34.3
12	20.3	20	36.3
13	22.3	21	38.3
14	24.3	22	40.3

SEE J-E5-61-A (FLAT CAM)
 SEE J-E5-71 (ROLLER CAM)

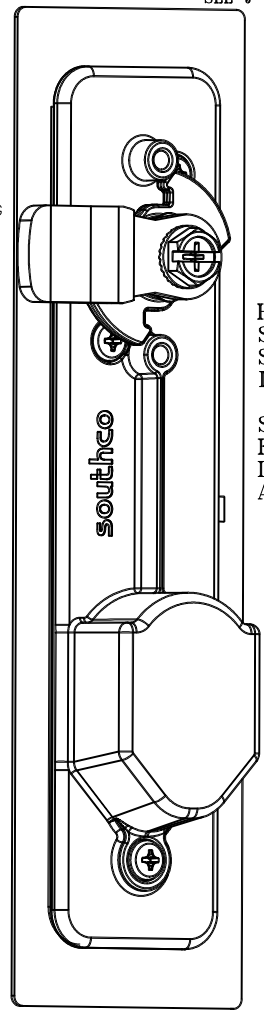
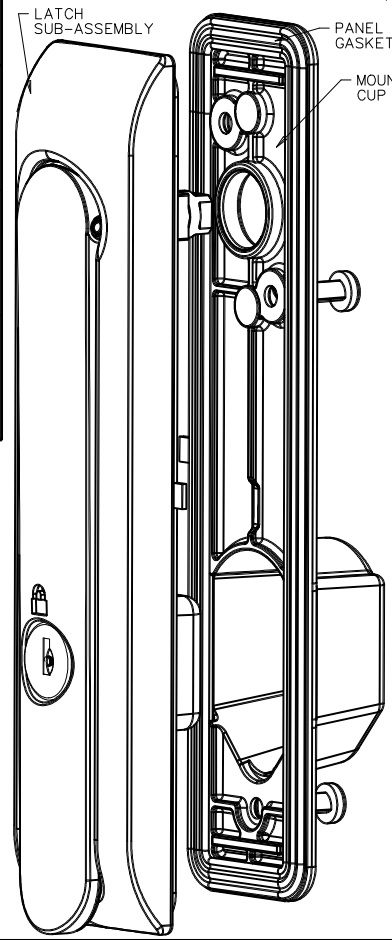

H3-60-303-1XX SHOWN AS A SINGLE POINT LATCH
 SEE SHEET 2 FOR VIEWS OF DIN AND TOOL ACCESS VERSIONS

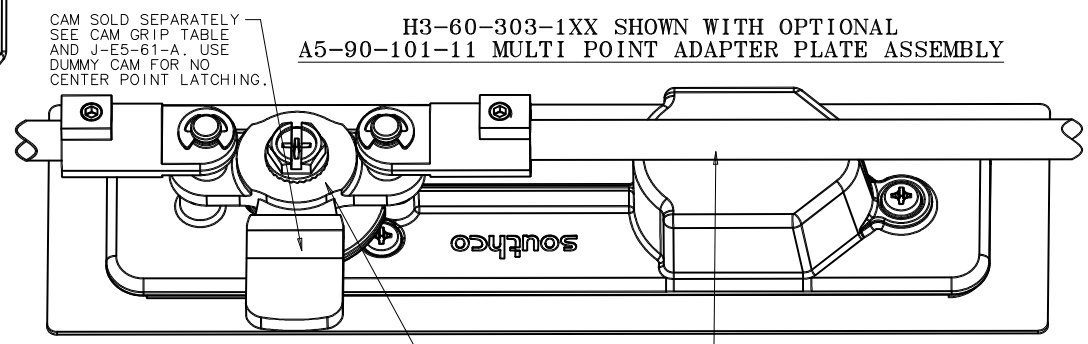

H3-60-303-1XX SHOWN WITH OPTIONAL A5-90-101-11 MULTI POINT ADAPTER PLATE ASSEMBLY

SEE J-A5-90-101-11

SEE J-A5-90 FOR ROD SYSTEM

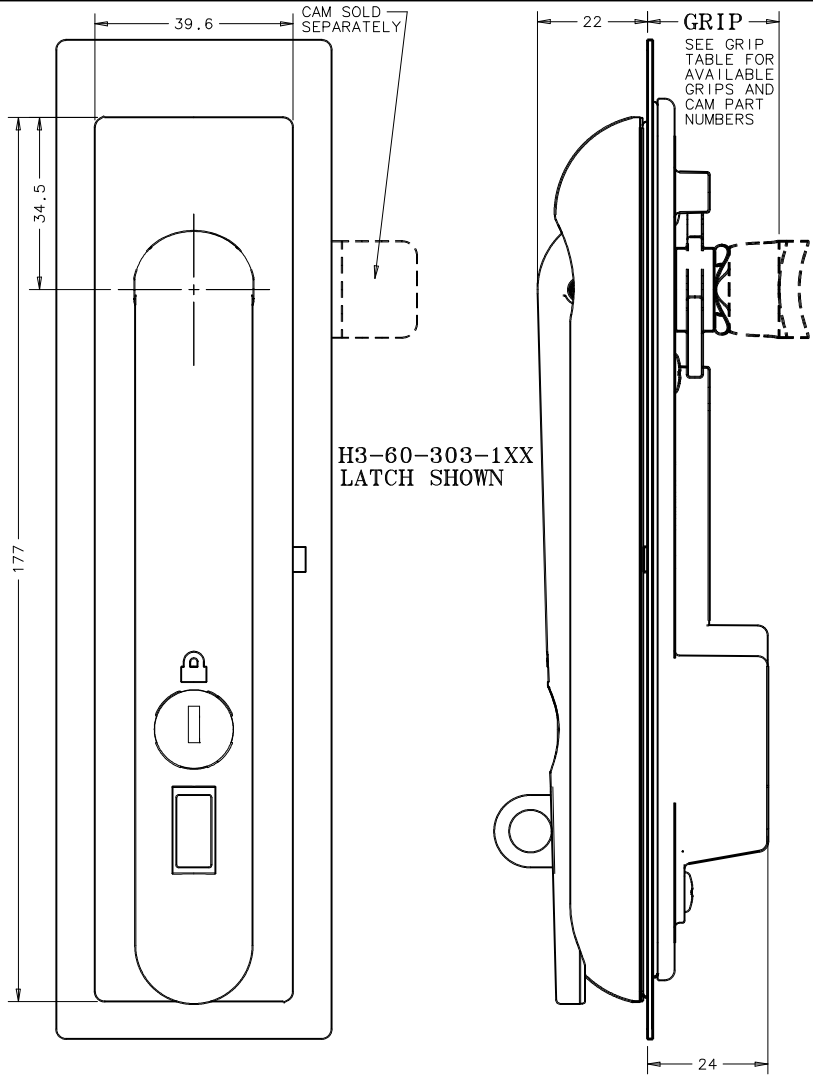

H3-60-303-1XX LATCH SHOWN

GRIP
 SEE GRIP TABLE FOR AVAILABLE GRIPS AND CAM PART NUMBERS

CAM SOLD SEPARATELY

CAM SOLD SEPARATELY
 SEE CAM GRIP TABLE AND J-E5-61-A. USE DUMMY CAM FOR NO CENTER POINT LATCHING.



REV	DATE	DESCRIPTION
A	03NOV2008	IR/DLH RELEASED FOR PRODUCTION
B	09 DEC 08	IR/ACH PRN: P2008-1345
C	04 FEB 09	IR/ACH PRN: P2009-0162
D	22AUG2011	MJ/S/MSR PRN: P2011-1073
E	22SEP2014	CM/S/BGL PRN: P2014-1872
F	05OCT2018	CM/S/CDW PRN: P2018-2534

DESCRIPTION	MATERIAL	FINISH/COLOR	DESCRIPTION	MATERIAL	FINISH/COLOR
HANDLE	ZAMAC 3	BLACK POWDERCOAT	HANDLE COVER	STEEL	
HOUSING			DISC SPRING		
MOUNTING CUP			DUMMY CAM		
TOOL ACTUATOR SHAFT			CAM SCREW		
ROTATION LIMITER			M4x7 SCREWS		
LOCKING PAWL			HANDLE PIN		
LOCK PLUG			PAWL SPRING		
DIN LOCK ASSY			WAVE WASHER		
PANEL GASKETS			PADLOCK HASP		
DIN DUST COVER			RETAINER		
HANDLE BUMPER			SHAFT O-RING		
			SCREW O-RINGS		

DRAWING NUMBER	SCALE	DRAWN	CHKD	DATE	DATE	DATE	DATE	DATE
J-H3-60-301-1				26 JUN 08				

MILLIMETERS
 ALL DIMENSIONS WITHOUT TOLERANCES ARE FOR REFERENCE ONLY.
 A3 PAPER SIZE
 THIRD ANGLE PROJECTION
SHEET 2 OF 2

PANEL PREPARATION

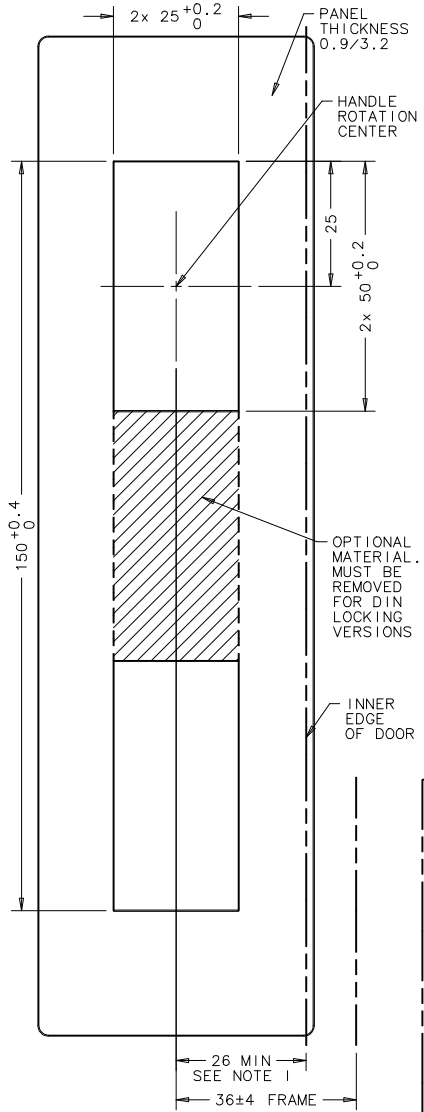

PROPER CAM & LIMITER INSTALLATION FOR ROTATING HANDLE CCW TO OPEN

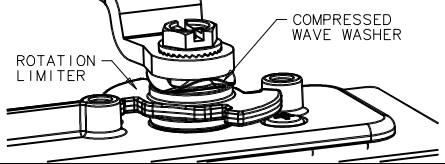

NOTES:

- ALL LATCH COMPONENTS ARE RoHS COMPLIANT.
- LATCH INSTALLATION:
 - PREPARE A BURR FREE PANEL OPENING AS SHOWN.
 - INSTALL LATCH SUB-ASSEMBLY FROM THE FRONT SIDE OF THE PANEL AND HOLD IN PLACE.
 - FROM THE BACK SIDE OF THE PANEL, SLIDE THE MOUNTING CUP ONTO THE HANDLE SHAFT.
 - SECURE THE CUP IN PLACE WITH THE THREE M4x0.7x12 SCREWS PROVIDED. MAX SCREW TORQUE 1.5 N-m.
 - PLACE THE ROTATION LIMITER ONTO THE HANDLE SHAFT. THE ROTATION LIMITER ALSO SETS THE ROTATION DIRECTION OF THE LATCH. TO FLIP ACTUATION DIRECTION, SIMPLY REMOVE THE ROTATION ACTUATION LIMITER FROM THE SHAFT, ROTATE IT 90°, AND PLACE BACK ONTO SHAFT.
 - PLACE SHAFT WAVE WASHER ONTO HANDLE SHAFT AGAINST THE TOP OF THE ROTATION LIMITER FOLLOWED BY THE CAM. THEN THE ACTUATOR PLATE ASSEMBLY IF USED. SECURE EVERYTHING TO THE SHAFT USING M6x1x14 SCREW. MAX SCREW TORQUE 2.0 N-m.
 - CYCLE THE LATCH FROM OPEN TO CLOSE TO MAKE SURE EVERYTHING MOVES FREELY.
 - FOR TWO POINT LATCHING (NO CENTER LATCHING), A 'DUMMY CAM' MUST BE USED TO MAINTAIN PROPER ASSEMBLY SPACING.
 - IF USED WITH SOUTHCO A5-90-101-11 ADAPTER PLATE ASSEMBLY.
- COSMETIC SPECIFICATION:

ALL POWDERCOATED AND CHROME PLATED SURFACES, UNLESS OTHERWISE NOTED, ARE TO CONFORM TO A CLASS 'B' DESIGNATION. ALL OTHER SURFACES, UNLESS OTHERWISE NOTED, ARE TO CONFORM TO A CLASS 'C' DESIGNATION AS DESCRIBED IN SOUTHCO COSMETIC SPECIFICATIONS:

 - S-121-01 FOR CHROME PLATING
 - S-121-02 FOR ZINC PLATING
 - S-121-03 FOR POWDER COATING
 - S-121-05 FOR STAINLESS STEEL PARTS

HARDWARE PACK

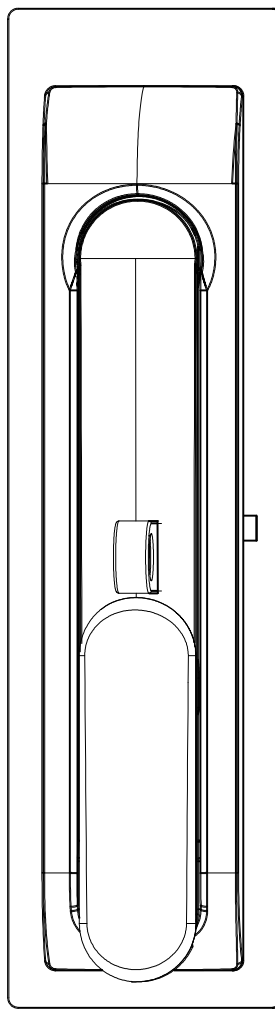
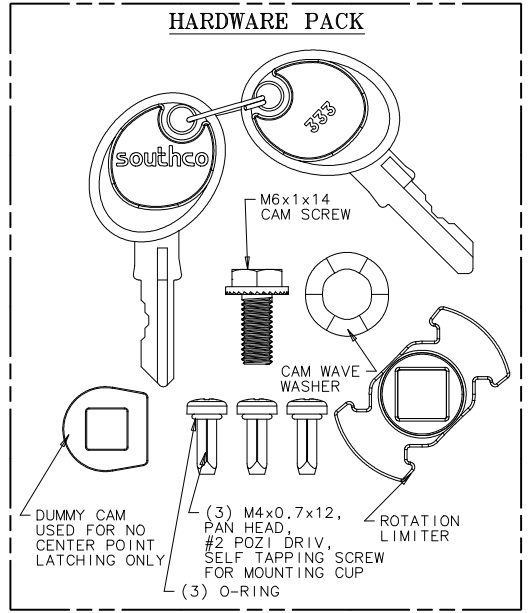

H3-50-423-1XX
333 DIN
WITH PADLOCK HASP

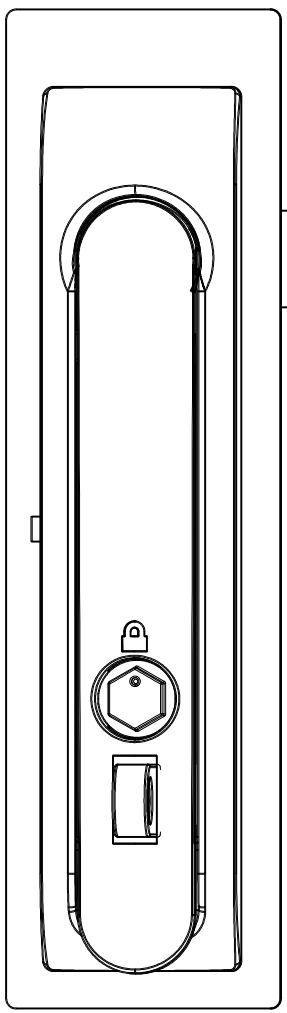

H3-50-442-1XX
BELLCORE/
TELCORDIA 216
WITH PADLOCK HASP

PROPER CAM, A5 ACTUATOR PLATE, & LIMITER INSTALLATION FOR ROTATING HANDLE CCW TO OPEN

