

THIS COPY IS PROVIDED ON A RESTRICTED BASIS AND IS NOT TO BE USED IN ANY WAY DETRIMENTAL TO THE INTERESTS OF PANDUIT CORP.

OPEN VIEW

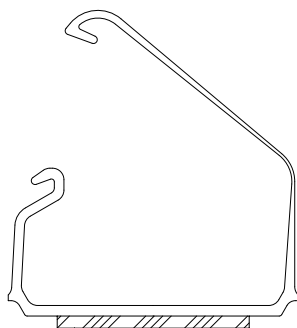

ADHESIVE BACKING
SEE NOTE 4

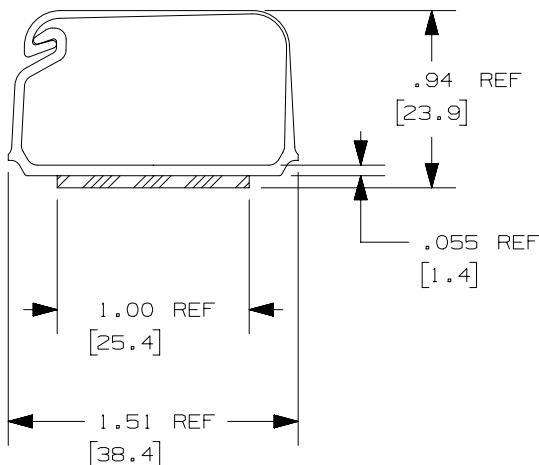

PART NAME	PANDUIT PART NUMBER (SEE NOTE 1)	LENGTH in. (mm.)	STATIC LOAD (SEE NOTE 2)	APPROX. WEIGHT
LATCHING DUCT	LD10**6-A	72.0±.13 (1829±3.3)	.61 lbs/in (10.9 g/mm)	.122 lbs/ft (.182 g/mm)
	LD10**8-A	96.0±.13 (2438±3.3)	.61 lbs/in (10.9 g/mm)	.122 lbs/ft (.182 g/mm)
	LD10**10-A	120.0±.13 (3048±3.3)	.61 lbs/in (10.9 g/mm)	.122 lbs/ft (.182 g/mm)
	LD10**2-A	78.74±.13 (2000.0±3.3)	.61 lbs/in (10.9 g/mm)	.122 lbs/ft (.182 g/mm)
	LD10**3-A	118.11±.13 (3000.0±3.3)	.61 lbs/in (10.9 g/mm)	.122 lbs/ft (.182 g/mm)

NOTES:

- VISIT OUR ON-LINE CATALOG AT WWW.PANDUIT.COM FOR A LIST OF ADDITIONAL PART NUMBER SUFFIXES TO INDICATE COLOR AND/OR PACKAGE QUANTITY.
- PART IS DESIGNED TO SUPPORT MAXIMUM WEIGHT ON A CLEAN, DRY, SMOOTH SURFACE. THE SURFACE MUST BE PROPERLY PREPARED IN ACCORDANCE WITH PANDUIT RECOMMENDATIONS.
- PANDUIT RECOMMENDATIONS:
 - IT IS RECOMMENDED THAT PANDUIT ADHESIVE TAPE BE APPLIED ON SURFACES WHOSE TEMPERATURE IS APPROXIMATELY 70°F (21°C) OR HIGHER FOR THE INITIAL BOND.
 - THE OPTIMUM RECOMMENDED DWELL TIME PRIOR TO LOADING FOR RUBBER ADHESIVE IS TWO HOURS.
 - PANDUIT TAPE SHOULD BE APPLIED TO A CLEAN, DRY, GREASE-FREE SURFACE WITH SUFFICIENT PRESSURE TO ASSURE GOOD ADHESIVE CONTACT. AVOID ADHESIVE CONTAMINATION WITH FOREIGN MATERIAL BY CLEANING WITH AN ISOPROPYL ALCOHOL OR A DEGREASER.
- PRESSURE SENSITIVE FOAM .040 [1.0] THICK WITH PROTECTIVE LINER.
- TO APPLY PART:
 - REMOVE PROTECTIVE LINER.
 - PLACE PART IN DESIRED LOCATION.
 - APPLY PRESSURE TO FLAT SURFACE OF PART.
- NO WARRANTY, EXPRESSED OR IMPLIED, IS MADE BY PANDUIT WITH RESPECT TO ADHESIVE BOND PERFORMANCE. THE CONDITIONS UNDER WHICH THESE MOUNTS MAY BE APPLIED AND/OR THE SURFACE TO WHICH THEY ARE APPLIED ARE BEYOND PANDUIT'S CONTROL.
- DIMENSIONS IN METRIC ARE IN [].

PART NUMBER		LD10	
TITLE		LATCHING DUCT	
CUSTOMER DRAWING			
ITEM REVISION NAME		D17832BA/04	
DATASET FILE NAME		D17832BA_DC_LD10/04B	
THIRD ANGLE PROJECTION		PANDUIT	
MATERIAL		PVC	
DRAWING NUMBER		SS-17832	
DRAWN BY	DATE	CHK	SCALE
GDN	11-19-82	HVP	NONE
SHEET 1 OF 1			SIZE
			A

REV	DATE	BY	CHK	APR	DESCRIPTION	ECN
04B	6-28-21	BJN	BSN	BETL	UPDATED NOTES	SS-17832